

MULTI PURPOSE WALL & METAL ROOF

THE ULTIMATE PROTECTION

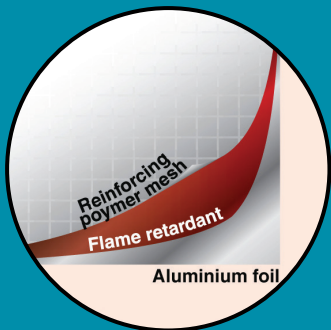

- ✓ Satisfy BCA specifications and requirements for Reflective Foil Laminates
- ✓ Complies with the specifications and requirements of AS/NZS 4200.1 for "Pliable Building Membranes" which is a manual recognised by the BCA Part 3.5 Roof and Cladding
- ✓ Low Flammability Index in accordance with AS 1530.2 < 5
- ✓ Satisfy BCA Part 3.7.1 Fire Hazard Properties
- ✓ Satisfy Health and Safety Regulations

PRODUCT INFORMATION

Thermacon Wrap Products are specifically manufactured to the highest industry standards.

WALL INSTALLATION - Up to R1.1 may be added to the wall system when Multi Purpose Wrap is installed as wall cladding behind brick veneer/timber cladding.

ROOF INSTALLATION - Up to R1.3 may be added to insulation system when Multi Purpose Wrap is installed.

Our specialised manufacturing process bonds together Aluminium Foil to a high strength reinforcing Polymer Mesh using a flame retardant adhesive. Our Reinforcing Polymer Mesh is purposely treated blue in colour to reduce reflective glare problems when Thermacon Multi Purpose wrap is installed.

MULTI PURPOSE WRAP USAGE

In all applications:

- External cladding should be installed A.S.A.P
- No contact is to be made with wet concrete or mortar
- Store in dry area, weather proofed only after installation
- Shrinkage of up to 2% can be expected

In reflective foil laminate applications:

- Use only in accordance with AS/NZS 4200.2 for the "Installation Requirements for Pliable Building Membranes"
- Minimum of 20MM air space is recommended adjacent to reflective foil face to achieve Maximum insulation values
- 40MM sag between trusses is recommended when using RP-51-WR
- For use in enclosed structures

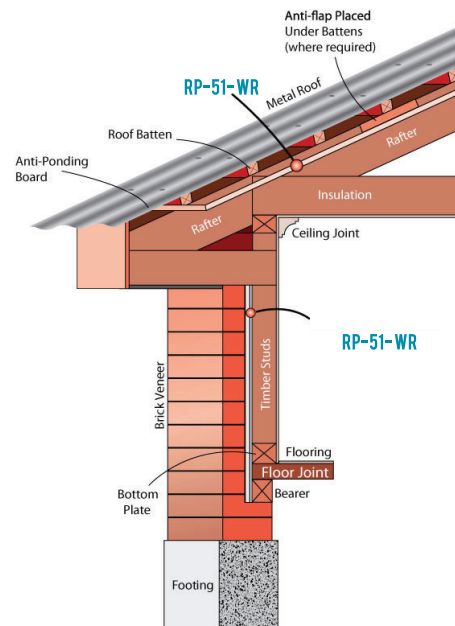

☎ (08) 9353 6033

📠 (08) 9353 6066

INFO@THERMACON.COM.AU

16-18 HODGSON WAY
KEWDALE WA 6105

WWW.THERMACON.COM.AU

Recommended Applications and Properties	
Residential & Commercial Wall & Roof Insulation	✓
Duty	Heavy
Vapour barrier	High
Emittance	Reflective
Water barrier	High
Flammability Index < 5	< 5
Tensile Strength Machine Direction (kN/M)	min 12.5
Tensile Strength Lateral Direction (kN/M)	min 7.5
Edge Tear Resistance Machine Direction (N)	min 80
Edge Tear Resistance Lateral Direction (N)	min 80
Water Vapour Transmission Rate (Ng/Ns)	max 2
Emittance of Reflective Face	max 0.05
Availability	
Width 1350MM	Length 30M Area 40.5M ²
Width 1350MM	Length 60M Area 81M ²